

STAINLESS STEEL BUTT-WELDING FITTINGS  
PRICE LIST

ステンレス製突合せ溶接式管継手

# 価格表

2017年版

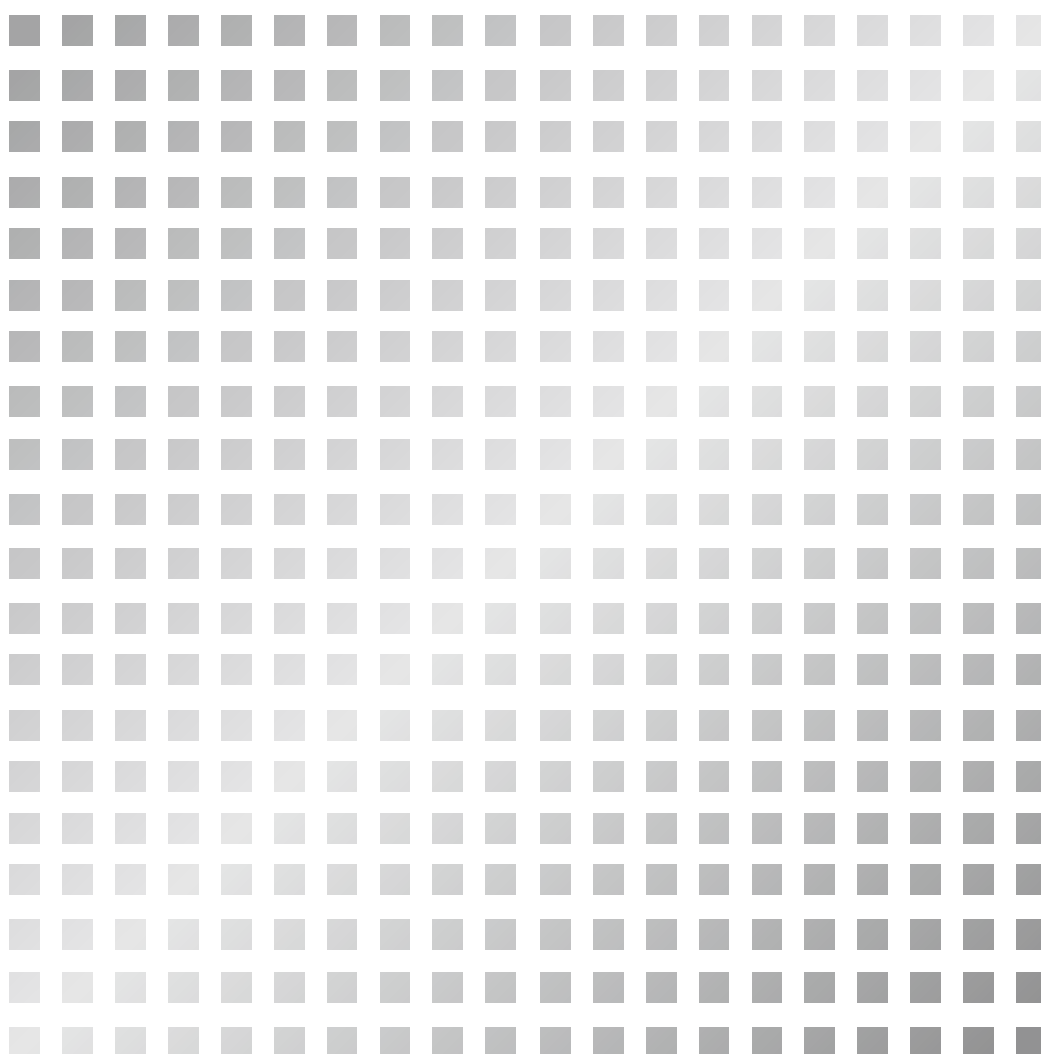

# STAINLESS STEEL BUTT-WELDING FITTINGS

単位:円

品名		90EL									品名	
材質		SUS304W			SUS316W			SUS316LW			材質	
寸法	厚さ	10S	20S	40S	10S	20S	40S	10S	20S	40S	寸法	厚さ
A	B										A	B
10A	3/8	800	1,200	1,600	1,600	2,000	2,800	2,200	3,100	4,400	10A	3/8
15A	1/2	800	1,200	1,600	1,600	2,000	2,800	2,200	3,100	4,400	15A	1/2
20A	3/4	800	1,200	1,600	1,600	2,000	2,800	2,200	3,100	4,400	20A	3/4
25A	1	800	1,200	1,600	1,600	2,000	2,800	2,200	3,100	4,400	25A	1
32A	11/4	900	1,300	1,800	1,700	2,200	3,200	2,300	3,500	5,100	32A	11/4
40A	11/2	1,000	1,500	2,200	2,000	2,400	3,600	3,000	3,900	5,900	40A	11/2
50A	2	1,600	2,000	3,200	2,800	3,300	5,400	4,200	5,300	8,600	50A	2
65A	21/2	2,700	4,000	5,300	4,600	6,200	10,400	6,600	10,100	15,200	65A	21/2
80A	3	3,600	5,500	7,600	6,200	8,700	14,800	9,000	15,200	20,800	80A	3
90A	31/2	11,200	17,700	26,300	21,300	32,000	50,100	28,300	48,200	67,900	90A	31/2
100A	4	6,200	9,000	15,900	10,500	16,300	26,200	14,600	24,700	42,900	100A	4
125A	5	11,200	16,300	23,200	18,900	28,300	44,300	26,300	44,700	63,100	125A	5
150A	6	16,200	23,800	41,700	27,400	45,500	69,000	38,100	65,000	113,400	150A	6
200A	8	33,900	60,800	85,900	56,500	110,700	149,700	88,500	165,600	232,700	200A	8
250A	10	53,400	83,500	135,200	89,200	163,900	236,300	139,900	237,800	366,300	250A	10
300A	12	91,600	143,300	230,100	153,000	249,000	405,500	240,000	408,100	624,300	300A	12

※  部分は受注生産になります。

単位:円

品名		90ES									品名	
材質		SUS304W			SUS316W			SUS316LW			材質	
寸法	厚さ	10S	20S	40S	10S	20S	40S	10S	20S	40S	寸法	厚さ
A	B										A	B
10A	3/8										10A	3/8
15A	1/2										15A	1/2
20A	3/4										20A	3/4
25A	1	900	1,400	2,000	2,000	2,300	3,200	2,600	3,800	5,300	25A	1
32A	11/4	1,000	1,500	2,200	2,100	2,500	3,700	2,900	4,300	6,000	32A	11/4
40A	11/2	1,300	1,700	2,600	2,300	2,900	4,400	3,600	4,700	7,000	40A	11/2
50A	2	1,900	2,400	3,800	3,200	4,000	6,300	5,100	6,500	10,400	50A	2
65A	21/2	3,000	4,500	6,400	5,500	7,500	12,300	8,100	12,200	18,300	65A	21/2
80A	3	4,100	6,300	9,100	7,500	10,500	17,900	10,800	17,000	25,000	80A	3
90A	31/2	13,400	21,300	31,600	25,500	38,400	60,100	34,000	57,800	81,500	90A	31/2
100A	4	6,600	10,400	19,000	12,500	19,700	31,400	17,600	29,600	51,500	100A	4
125A	5	12,000	18,900	27,900	22,500	33,900	53,100	31,600	53,700	75,700	125A	5
150A	6	17,500	27,800	50,100	32,800	54,700	82,700	45,800	78,000	136,000	150A	6
200A	8	37,400	73,500	103,000	67,500	132,700	179,600	106,500	199,000	279,400	200A	8
250A	10	59,000	100,300	162,200	106,800	196,400	283,500	168,000	285,600	439,900	250A	10
300A	12	101,200	171,900	276,300	183,300	298,500	486,600	288,200	489,800	749,100	300A	12

※  部分は受注生産になります。

# STAINLESS STEEL BUTT-WELDING FITTINGS

単位:円

品名		45EL									品名	
材質		SUS304W			SUS316W			SUS316LW			材質	
寸法	厚さ	10S	20S	40S	10S	20S	40S	10S	20S	40S	寸法	厚さ
A	B										A	B
10A	3/8	700	900	1,300	1,300	1,600	2,200	1,800	2,600	3,600	10A	3/8
15A	1/2	700	900	1,300	1,300	1,600	2,200	1,800	2,600	3,600	15A	1/2
20A	3/4	700	900	1,300	1,300	1,600	2,200	1,800	2,600	3,600	20A	3/4
25A	1	700	900	1,300	1,300	1,600	2,200	1,800	2,600	3,600	25A	1
32A	11/4	800	1,000	1,500	1,500	1,700	2,500	2,100	2,900	4,200	32A	11/4
40A	11/2	900	1,200	1,700	1,600	2,000	3,000	2,300	3,100	4,700	40A	11/2
50A	2	1,200	1,600	2,400	2,200	2,800	4,300	3,000	4,300	6,900	50A	2
65A	21/2	2,100	3,000	4,300	3,700	4,900	8,300	5,300	8,200	12,200	65A	21/2
80A	3	2,800	4,100	6,100	4,900	7,000	12,000	7,000	11,400	16,400	80A	3
90A	31/2	9,000	14,200	21,100	17,000	25,600	40,400	22,700	38,500	54,500	90A	31/2
100A	4	5,000	7,100	12,700	8,400	13,100	20,900	12,000	20,500	34,300	100A	4
125A	5	9,000	12,500	18,600	15,100	22,700	35,800	21,100	35,800	50,600	125A	5
150A	6	13,000	18,300	33,500	22,000	36,500	55,200	30,700	52,100	90,700	150A	6
200A	8	25,000	49,000	68,700	45,200	88,700	119,900	70,700	132,600	186,200	200A	8
250A	10	39,300	66,800	108,100	71,300	131,100	189,300	111,800	190,200	293,000	250A	10
300A	12	67,500	114,800	184,100	122,400	199,200	324,400	192,000	326,600	499,300	300A	12

※  部分は受注生産になります。

単位:円

品名		キャップ						ラップジョイント(10Kタイプ)			品名	
材質		SUS304			SUS316L			SUS304			材質	
寸法	厚さ	10S	20S	40S	10S	20S	40S	10S	20S	40S	寸法	厚さ
A	B										A	B
10A	3/8	-	-	-	-	-	-	2,700	3,400	3,600	10A	3/8
15A	1/2	1,200	1,300	1,400	1,300	-	-	1,800	2,000	2,400	15A	1/2
20A	3/4	1,200	1,300	1,400	1,300	-	-	1,800	2,000	2,400	20A	3/4
25A	1	1,300	1,400	1,600	1,300	-	-	1,800	2,000	2,400	25A	1
32A	11/4	1,450	1,550	2,000	1,500	-	-	2,200	2,300	2,600	32A	11/4
40A	11/2	1,500	1,600	2,200	1,600	-	-	2,200	2,500	2,900	40A	11/2
50A	2	1,900	2,800	3,000	2,200	-	-	2,700	3,400	3,600	50A	2
65A	21/2	2,350	3,100	3,500	3,700	-	-	3,000	3,600	6,800	65A	21/2
80A	3	3,000	3,700	4,800	4,900	-	-	3,300	4,500	7,600	80A	3
90A	31/2	-	-	-	-	-	-	-	-	-	90A	31/2
100A	4	4,300	5,400	7,300	8,400	-	-	4,100	5,600	10,900	100A	4
125A	5	6,800	8,600	11,200	15,100	-	-	5,400	8,400	15,000	125A	5
150A	6	9,100	10,600	14,800	22,000	-	-	7,200	10,200	19,400	150A	6
200A	8	17,100	26,600	34,600	45,200	-	-	12,300	20,600	36,800	200A	8
250A	10	25,000	41,800	57,000	71,300	-	-	16,500	27,300	53,800	250A	10
300A	12	39,500	59,000	-	122,400	-	-	23,100	35,300	62,400	300A	12

※  部分は受注生産になります。

# STAINLESS STEEL BUTT-WELDING FITTINGS

単位:円

品名		TS									品名	
材質		SUS304W			SUS316W			SUS316LW			材質	
寸法	厚さ	10S	20S	40S	10S	20S	40S	10S	20S	40S	寸法	厚さ
A	B										A	B
10A	3/8	2,000	3,200	4,300	3,500	4,900	6,800	5,300	8,200	10,900	10A	3/8
15A	1/2	2,000	3,200	4,300	3,500	4,900	6,800	5,300	8,200	10,900	15A	1/2
20A	3/4	2,000	3,200	4,300	3,500	4,900	6,800	5,300	8,200	10,900	20A	3/4
25A	1	2,000	3,200	4,300	3,500	4,900	6,800	5,300	8,200	10,900	25A	1
32A	11/4	2,100	3,300	4,600	4,300	5,800	8,300	5,700	9,400	13,100	32A	11/4
40A	11/2	2,200	3,600	4,800	4,500	6,000	8,600	6,000	9,800	13,500	40A	11/2
50A	2	2,700	4,300	5,300	4,800	8,300	9,900	6,600	11,300	15,200	50A	2
65A	21/2	4,300	6,300	9,900	7,800	12,400	17,900	10,700	18,200	26,800	65A	21/2
80A	3	5,900	8,600	13,100	10,700	16,700	24,600	14,600	24,700	35,600	80A	3
90A	31/2	14,600	24,600	35,300	26,100	44,300	60,000	35,500	66,700	95,800	90A	31/2
100A	4	8,500	13,800	23,300	15,200	26,100	38,500	20,800	37,300	63,200	100A	4
125A	5	14,600	24,600	35,300	26,100	44,300	60,000	35,500	66,700	95,800	125A	5
150A	6	17,300	32,700	50,800	33,400	56,600	84,000	45,200	88,500	137,800	150A	6
200A	8	40,000	63,900	91,900	72,100	125,700	177,000	104,900	178,400	249,300	200A	8
250A	10	59,900	94,400	150,200	108,200	185,500	265,000	157,000	267,200	407,600	250A	10
300A	12	79,900	126,300	210,300	144,200	247,900	353,400	209,400	356,200	570,600	300A	12

※  部分は受注生産になります。

単位:円

品名		異径チーズTR									品名	
材質		SUS304W			SUS316W			SUS316LW			材質	
寸法	厚さ	10S	20S	40S	10S	20S	40S	10S	20S	40S	寸法	厚さ
A	B										A	B
20×15	3/4×1/2	2,300	3,800	5,100	4,400	6,200	8,400	6,200	10,100	13,800	20×15	3/4×1/2
25×20-15	1×3/4-1/2	2,300	3,800	5,100	4,400	6,200	8,400	6,200	10,100	13,800	25×20-15	1×3/4-1/2
32×25~15	11/4×1/2	2,400	4,100	5,600	5,100	7,200	10,400	7,000	11,700	16,100	32×25~15	11/4×1/2
40×15	11/2×1/2	3,000	5,200	6,900	6,200	8,600	12,300	8,600	14,000	19,800	40×15	11/2×1/2
40×32~20	11/2×11/4~3/4	2,500	4,400	5,900	5,300	7,500	10,600	7,400	12,100	16,900	40×32~20	11/2×11/4~3/4
50×20-15	2×3/4-1/2	3,600	6,300	7,700	7,100	12,100	14,800	9,600	17,200	22,100	50×20-15	2×3/4-1/2
50×40~25	2×11/2-1	3,100	5,300	6,700	6,000	10,500	12,400	8,300	14,400	19,100	50×40~25	2×11/2-1
65×25	21/2×1	5,900	9,400	14,800	11,400	18,600	26,300	15,500	26,300	40,000	65×25	21/2×1
65×50~32	21/2×2~11/4	5,000	7,900	12,300	9,700	15,500	22,200	13,100	22,400	33,400	65×50~32	21/2×2~11/4
80×32-25	3×11/4-1	8,100	12,800	19,700	15,800	24,800	36,100	21,500	36,500	53,400	80×32-25	3×11/4-1
80×65~40	3×21/2~11/2	6,800	10,600	16,400	13,100	20,800	30,100	17,800	30,300	44,500	80×65~40	3×21/2~11/2
100×50-40	4×2-11/2	11,800	20,600	35,000	22,700	38,500	57,700	30,900	55,900	94,900	100×50-40	4×2-11/2
100×80-65	4×3-21/2	9,900	17,300	29,200	19,200	32,500	48,100	26,000	46,700	79,000	100×80-65	4×3-21/2
125×65-50	5×21/2-2	20,300	36,800	53,000	39,000	66,500	89,700	53,300	99,800	143,800	125×65-50	5×21/2-2
125×100-80	5×4-3	16,900	30,700	44,200	32,500	55,300	74,900	44,300	83,300	119,900	125×100-80	5×4-3
150×80	6×3	24,800	51,100	79,600	52,100	88,300	131,300	67,900	132,900	206,600	150×80	6×3
150×125-100	6×5-4	20,800	40,800	63,500	41,600	71,100	104,800	56,800	110,600	172,300	150×125-100	6×5-4
200×150~100	8×6~4	47,900	79,900	114,900	90,300	157,100	220,800	130,800	222,600	311,700	200×150~100	8×6~4
250×200-150	10×8-6	71,900	118,000	187,800	135,200	231,800	331,300	196,300	333,800	509,300	250×200-150	10×8-6
300×250-200	12×10-8	95,800	157,800	262,900	180,300	309,900	441,400	261,600	444,600	713,300	300×250-200	12×10-8

※  部分は受注生産になります。

# STAINLESS STEEL BUTT-WELDING FITTINGS

単位:円

品名		コンセントリック・レジャーサーRC									品名	
材質		SUS304W			SUS316W			SUS316LW			材質	
寸法	厚さ	10S	20S	40S	10S	20S	40S	10S	20S	40S	寸法	厚さ
A	B										A	B
20×15	3/4×1/2	1,200	1,600	2,000	2,300	2,800	3,300	3,100	4,300	5,300	20×15	3/4×1/2
25×20-15	1×3/4-1/2	1,200	1,600	2,000	2,300	2,800	3,300	3,100	4,300	5,300	25×20-15	1×3/4-1/2
32×25~15	1 1/4×1/2	1,300	1,700	2,200	2,400	3,000	3,700	3,400	4,600	5,900	32×25~15	1 1/4×1/2
40×15	1 1/2×1/2	1,500	2,200	2,600	3,100	3,500	4,400	4,100	5,700	7,100	40×15	1 1/2×1/2
40×32~20	1 1/2×1 1/4~3/4	1,400	2,000	2,400	2,800	3,200	4,000	3,800	5,200	6,500	40×32~20	1 1/2×1 1/4~3/4
50×20-15	2×3/4-1/2	1,700	2,800	3,600	3,500	4,700	5,900	4,700	7,700	9,600	50×20-15	2×3/4-1/2
50×40~25	2×1 1/2~1	1,600	2,500	3,200	3,200	4,300	5,400	4,400	6,900	8,600	50×40~25	2×1 1/2~1
65×25	2 1/2×1	2,200	3,600	5,000	4,500	5,400	8,600	6,300	8,900	14,000	65×25	2 1/2×1
65×50~32	2 1/2×2~1 1/4	2,000	3,300	4,600	4,100	4,900	7,800	5,700	8,100	12,700	65×50~32	2 1/2×2~1 1/4
80×32-25	3×1 1/4-1	2,700	4,900	6,200	5,400	8,200	10,900	7,700	13,200	17,700	80×32-25	3×1 1/4-1
80×65~40	3×2 1/2~1 1/2	2,400	4,500	5,600	4,900	7,500	9,900	7,000	12,000	16,100	80×65~40	3×2 1/2~1 1/2
100×50-40	4×2-1 1/2	3,900	6,700	9,100	8,300	10,900	17,700	11,300	17,900	26,000	100×50-40	4×2-1 1/2
100×80-65	4×3-2 1/2	3,600	6,000	8,300	7,500	9,900	16,100	10,400	16,300	23,800	100×80-65	4×3-2 1/2
125×65-50	5×2 1/2-2	7,000	12,000	16,200	14,700	23,200	31,300	20,200	34,200	46,400	125×65-50	5×2 1/2-2
125×100-80	5×4-3	6,400	11,000	14,800	13,600	21,000	28,500	18,500	31,600	42,400	125×100-80	5×4-3
150×80-65	6×3	8,300	14,600	20,800	17,400	28,600	40,000	23,800	40,400	56,400	150×80	6×3
150×125-100	6×5-4	7,600	13,200	18,900	16,000	26,000	36,600	21,700	37,200	51,200	150×125-100	6×5-4
200×150~100	8×6~4	14,500	24,700	33,400	28,500	45,800	69,800	41,300	70,600	95,000	200×150~100	8×6~4
250×200-150	10×8-6	23,300	39,800	53,700	45,800	68,000	112,400	66,700	111,500	153,100	250×200-150	10×8-6
300×250-200	12×10-8	33,900	57,700	78,100	66,700	99,900	151,800	96,700	164,600	222,600	300×250-200	12×10-8

※  部分は受注生産になります。

単位:円

品名		エキセントリック・レジャーサーRE									品名	
材質		SUS304W			SUS316W			SUS316LW			材質	
寸法	厚さ	10S	20S	40S	10S	20S	40S	10S	20S	40S	寸法	厚さ
A	B										A	B
20×15	3/4×1/2	1,500	2,400	3,200	3,000	4,100	5,400	4,400	6,600	8,600	20×15	3/4×1/2
25×20-15	1×3/4-1/2	1,500	2,400	3,200	3,000	4,100	5,400	4,400	6,600	8,600	25×20-15	1×3/4-1/2
32×25~15	1 1/4×1/2	1,600	2,600	3,500	3,500	4,400	5,800	4,700	6,900	9,000	32×25~15	1 1/4×1/2
40×15	1 1/2×1/2	2,000	3,200	4,100	4,400	5,300	6,700	5,800	8,600	11,000	40×15	1 1/2×1/2
40×32~20	1 1/2×1 1/4~3/4	1,800	2,900	3,700	4,000	4,800	6,100	5,300	7,800	10,000	40×32~20	1 1/2×1 1/4~3/4
50×20-15	2×3/4-1/2	2,400	4,200	5,200	5,200	6,800	8,600	6,800	11,100	14,000	50×20-15	2×3/4-1/2
50×40~25	2×1 1/2~1	2,200	3,800	4,700	4,700	6,200	7,800	6,200	10,100	12,700	50×40~25	2×1 1/2~1
65×25	2 1/2×1	3,200	4,900	7,400	6,700	8,100	12,900	9,100	13,300	21,000	65×25	2 1/2×1
65×50~32	2 1/2×2~1 1/4	2,900	4,500	6,700	6,100	7,400	11,700	8,300	12,100	19,100	65×50~32	2 1/2×2~1 1/4
80×32-25	3×1 1/4-1	4,000	6,600	9,100	8,300	10,900	17,700	11,400	17,900	26,200	80×32-25	3×1 1/4-1
80×65~40	3×2 1/2~1 1/2	3,600	6,000	8,300	7,500	9,900	16,100	10,400	16,300	23,800	80×65~40	3×2 1/2~1 1/2
100×50-40	4×2-1 1/2	5,800	10,000	16,000	12,300	16,300	28,200	16,700	26,800	43,300	100×50-40	4×2-1 1/2
100×80-65	4×3-2 1/2	5,300	9,100	14,500	11,200	14,800	25,600	15,200	24,400	39,400	100×80-65	4×3-2 1/2
125×65-50	5×2 1/2-2	10,800	18,400	25,000	22,700	35,300	46,200	30,900	52,500	71,200	125×65-50	5×2 1/2-2
125×100-80	5×4-3	9,900	16,900	22,800	20,800	32,200	42,100	28,300	48,200	65,000	125×100-80	5×4-3
150×80-65	6×3	12,800	22,200	31,900	26,800	43,600	61,600	36,500	62,000	86,300	150×80	6×3
150×125-100	6×5-4	11,600	20,100	29,000	24,400	39,600	56,100	33,300	56,600	78,500	150×125-100	6×5-4
200×150~100	8×6~4	21,400	36,500	49,200	44,900	68,000	92,700	61,100	104,000	140,300	200×150~100	8×6~4
250×200-150	10×8-6	34,600	58,900	79,700	72,500	101,200	149,300	98,800	166,400	227,200	250×200-150	10×8-6
300×250-200	12×10-8	50,900	86,700	117,200	106,600	149,300	224,600	145,300	247,100	333,800	300×250-200	12×10-8

※  部分は受注生産になります。

一般配管用ステンレス鋼管  
突合せ溶接式管継手建値表

SAS-354

Su継手

価格表

2017年版

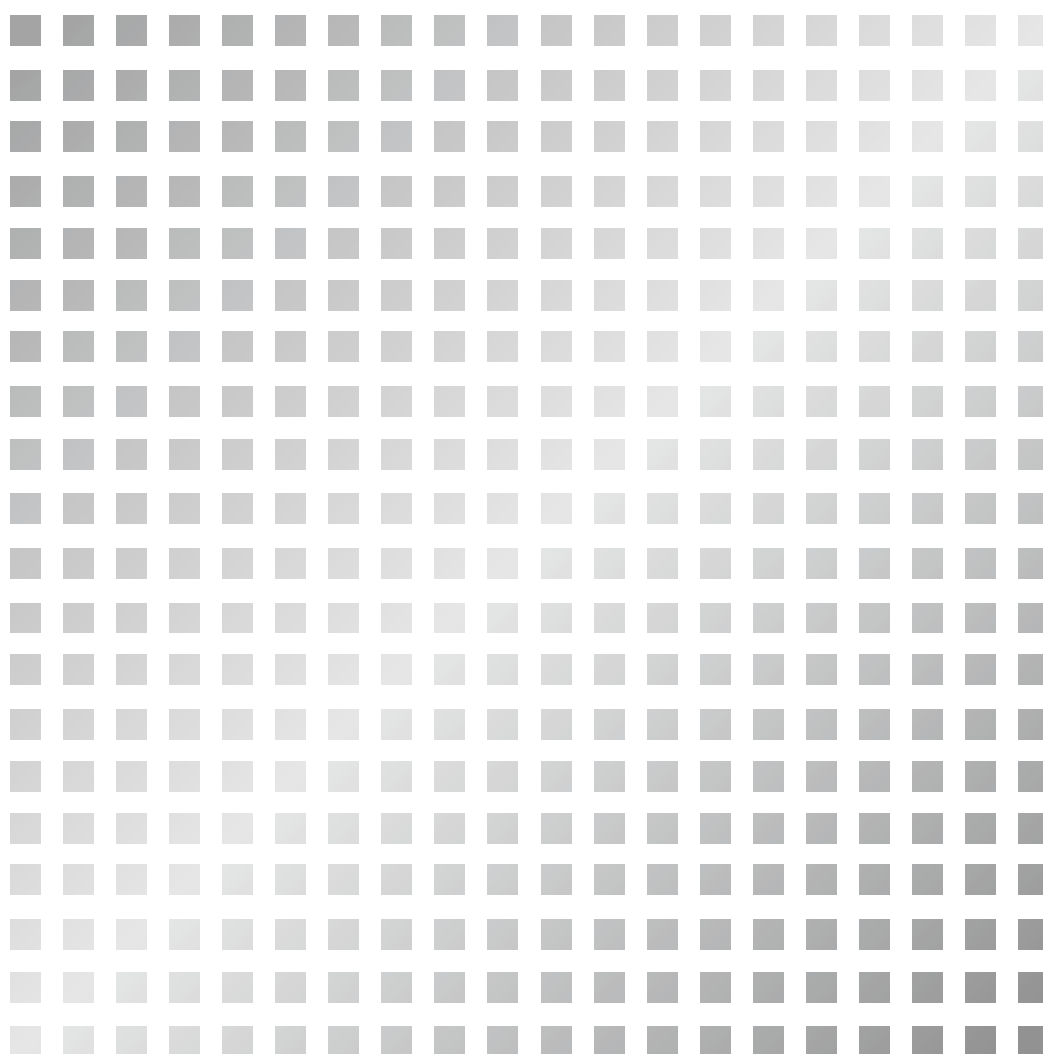

# Su継手

## 90E(L),90E(S)

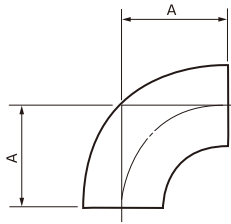

90°ロングエルボ、90°ショートエルボ 単位:円

呼び径 (Su)	90°ロングエルボ		90°ショートエルボ	
	A	SUS304WD	A	SUS304WD
30	38.1	2,700	25.4	3,100
40	47.6	3,100	31.8	3,100
50	57.2	3,100	38.1	3,100
60	76.2	4,400	50.8	4,600
75	95.3	6,800	63.5	8,300
80	114.3	8,500	76.2	10,300
100	152.4	12,800	101.6	15,700
125	190.5	26,800	127.0	32,700
150	228.6	32,600	152.4	38,600
200	304.8	65,300	203.2	79,500
250	381.0	116,500	254.0	146,600
300	457.2	181,600	304.8	227,100

## 45E(L)

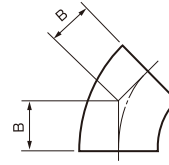

45°ロングエルボ 単位:円

呼び径 (Su)	B	SUS304WD
30	15.8	1,700
40	19.7	2,200
50	23.7	2,200
60	31.6	3,200
75	39.5	5,400
80	47.3	6,700
100	63.1	10,300
125	78.9	21,400
150	94.7	26,200
200	126.3	51,200
250	157.8	90,800
300	189.4	144,900

## L(10K)

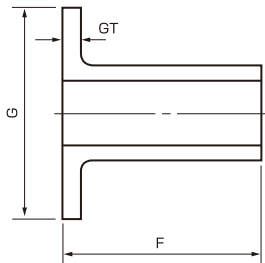

ラップジョイント 単位:円

呼び径 (Su)	F	G	GT	SUS304WD
30	50	67	2.8	2,700
40	50	76	2.8	3,800
50	50	81	2.8	3,800
60	50	96	2.8	4,100
75	50	116	3.0	4,900
80	50	126	3.0	5,200
100	50	151	3.0	6,600
125	50	182	3.4	9,300
150	50	212	3.4	10,400
200	65	262	4.0	20,100
250	65	324	4.0	29,710
300	65	368	4.5	39,200

## CAP

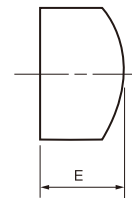

キャップ 単位:円

呼び径 (Su)	E	SUS304WD
30	38.1	4,810
40	38.1	5,510
50	38.1	5,800
60	38.1	6,100
75	38.1	6,600
80	50.8	7,800
100	63.5	11,300
125	76.2	17,800
150	88.9	23,800
200	101.6	45,200
250	127.0	65,700
300	152.4	106,600

## T(S)

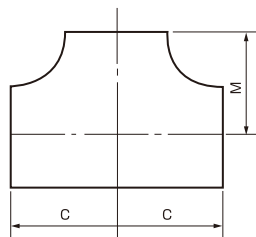

同径チーズ

単位:円

呼び径 (Su)	C	M	SUS304WD
30	38.1	38.1	7,300
40	47.6	47.6	7,900
50	57.2	57.2	7,900
60	63.5	63.5	9,500
75	76.2	76.2	13,900
80	85.7	85.7	15,400
100	104.8	104.8	22,700
125	123.8	123.8	44,700
150	142.9	142.9	48,000
200	177.8	177.8	95,700
250	215.9	215.9	172,300
300	254.0	254.0	242,400

## 管継手の外径及び厚さ

単位:mm

呼び径 (Su)	外径	厚さ
30	34.0	1.2
40	42.7	1.2
50	48.6	1.2
60	60.5	1.5
75	76.3	1.5
80	89.1	2.0
100	114.3	2.0
125	139.8	2.0
150	165.2	3.0
200	216.3	3.0
250	267.4	3.0
300	318.5	3.0

## T(R)

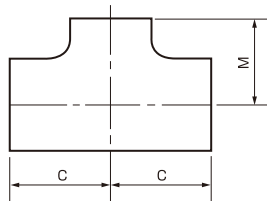

異径チーズ

単位:円

呼び径 (Su)	C	M	SUS304WD
40 × 40 × 30	47.6	47.6	9,900
50 × 50 × 40	57.2	57.2	9,900
50 × 50 × 30	57.2	57.2	9,900
60 × 60 × 50	63.5	60.3	11,800
60 × 60 × 40	63.5	57.2	11,800
75 × 75 × 60	76.2	69.9	15,300
75 × 75 × 50	76.2	66.7	15,300
80 × 80 × 75	85.7	82.6	19,400
80 × 80 × 60	85.7	76.2	19,400
100 × 100 × 80	104.8	98.4	24,900
100 × 100 × 75	104.8	95.3	24,900
125 × 125 × 100	123.8	117.5	55,800
125 × 125 × 80	123.8	111.1	55,800
150 × 150 × 125	142.9	136.5	59,900
150 × 150 × 100	142.9	130.2	59,900
200 × 200 × 150	177.8	168.3	119,700
200 × 200 × 125	177.8	161.9	119,700
250 × 250 × 200	215.9	203.2	216,400
250 × 250 × 150	215.9	193.7	216,400
300 × 300 × 250	254.0	241.3	303,000
300 × 300 × 200	254.0	228.6	303,000

※T(R)の3段階以上は、30%Upとなります。

## R(C),R(E)

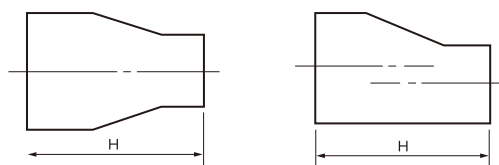

同芯レジュューサ、偏芯レジュューサ

単位:円

呼び径 (Su)	H	SUS304WD	
		同芯 RC	偏芯 RE
40 × 30	50.8	3,500	5,100
50 × 40	63.5	3,500	5,100
50 × 30	63.5	3,500	5,100
60 × 50	76.2	3,600	5,400
60 × 40	76.2	3,600	5,400
75 × 60	88.9	4,500	6,700
75 × 50	88.9	4,500	6,700
80 × 75	88.9	4,900	7,200
80 × 60	88.9	4,900	7,200
100 × 80	101.6	6,700	10,000
100 × 75	101.6	6,700	10,000
125 × 100	127.0	16,400	22,200
125 × 80	127.0	16,400	22,200
150 × 125	139.7	18,800	25,500
150 × 100	139.7	18,800	25,500
200 × 150	152.4	30,500	45,700
200 × 125	152.4	30,500	45,700
250 × 200	177.8	48,500	71,800
250 × 150	177.8	48,500	71,800
300 × 250	203.2	71,200	106,600
300 × 200	203.2	71,200	106,600

※R(C)、R(E)の3段階以上は、30%Upとなります。